

# SOUTH CUMBERLAND ELEMENTARY SCHOOL

**\*** This diagram must be post in each classroom with your route Highlighted

## EVACUATION ROUTES

for Fire or Bomb

**\*** One designated student from each class must report to office personnel in front of building

PLAY GROUND

**\*** Also, each teacher needs to make sure that all students know this procedure and a copy of this is to be placed in the substitute teacher folder

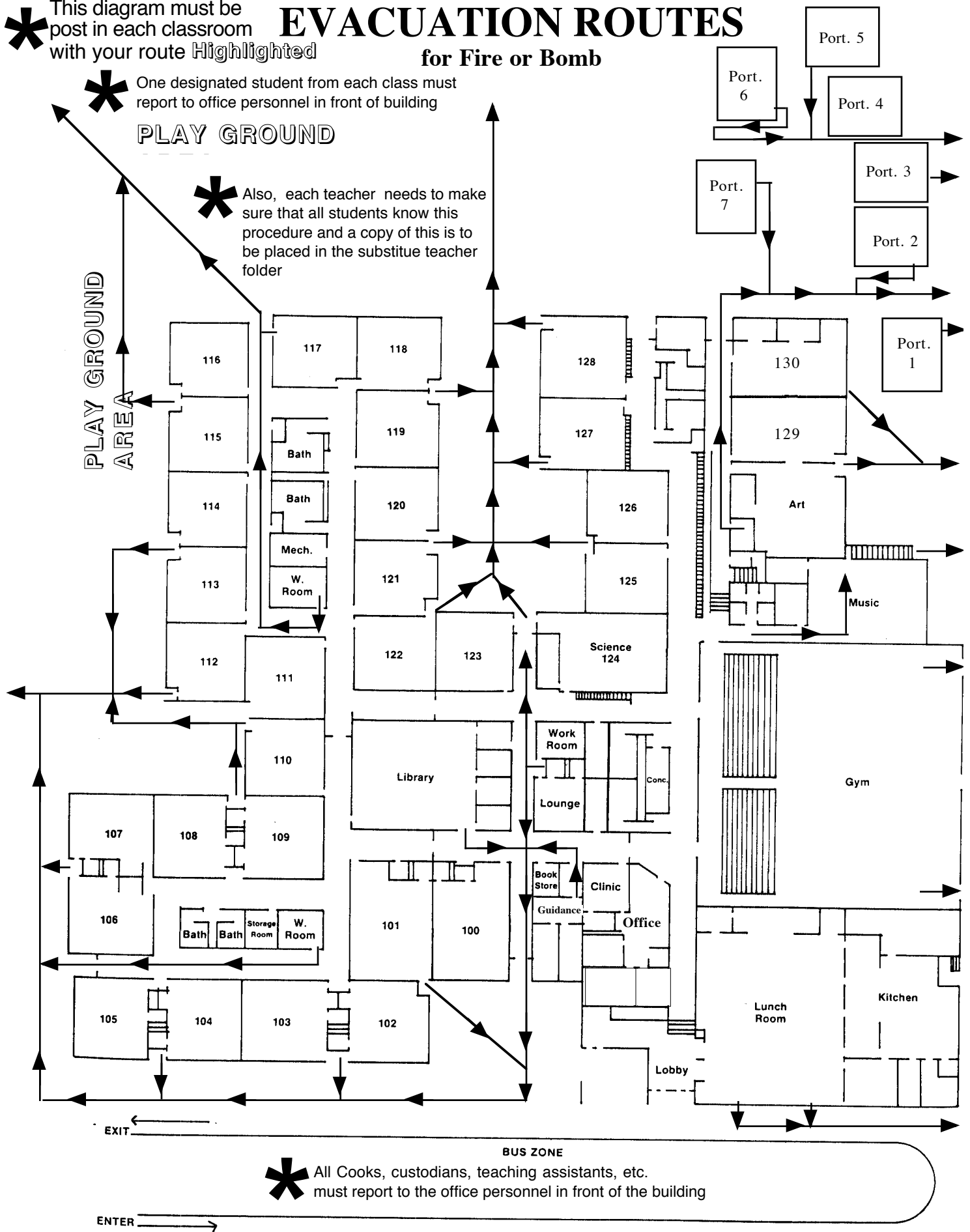

**\*** All Cooks, custodians, teaching assistants, etc. must report to the office personnel in front of the building